

CALIFORNIA REGIONAL WATER QUALITY CONTROL BOARD
CENTRAL VALLEY REGION

MONITORING AND REPORTING PROGRAM NO. 99-124
FOR
SOUTHEAST REGIONAL SOLID WASTE COMMISSION
FOR
POST-CLOSURE MAINTENANCE
SOUTHEAST REGIONAL MUNICIPAL SOLID WASTE LANDFILL
FRESNO COUNTY

Compliance with this Monitoring and Reporting Program, with Title 27, California Code of Regulations, Section 20005, et seq. (hereafter Title 27), and with the Standard Provisions and Reporting Requirements dated August 1997, is ordered by Waste Discharge Requirements Order No. 99-124.

Failure to comply with this Program, or with the Standard Provisions and Reporting Requirements, constitutes noncompliance with the Waste Discharge Requirements and with the California Water Code, which can result in the imposition of civil monetary liability.

A. REQUIRED MONITORING REPORTS

<u>Report</u>	<u>Due</u>
1. Groundwater Monitoring (Section D.1)	See Table I
2. Annual Monitoring Summary Report (Standard Provisions and Reporting Requirements)	Annually
3. Facility Monitoring (Section D.5)	As necessary
4. Response to a Release (Standard Provisions and Reporting Requirements)	As necessary

B. REPORTING

The Discharger shall report monitoring data and information as required in this Monitoring and Reporting Program and as required in the Standard Provisions and Reporting Requirements. Reports which do not comply with the required format will be **REJECTED** and the Discharger shall be deemed to be in noncompliance with the waste discharge requirements. In reporting the monitoring data required by this program, the Discharger shall arrange the data in tabular form so that the date, the constituents, the concentrations, and the units are readily discernible. Data shall also be submitted in a digital database format acceptable to the Executive Officer. The data shall be summarized in such a manner so as to illustrate clearly the compliance with waste discharge requirements or the lack

MONITORING AND REPORTING PROGRAM NO. 99-124
 SOUTHEAST REGIONAL SOLID WASTE COMMISSION
 POST-CLOSURE MAINTENANCE
 SOUTHEAST REGIONAL MUNICIPAL SOLID WASTE LANDFILL
 FRESNO COUNTY

-2-

thereof. A short discussion of the monitoring results, including notations of any water quality violations, shall precede the tabular summaries.

Field and laboratory tests shall be reported in each monitoring report. Monthly, quarterly, semiannual, and annual monitoring reports shall be submitted to Board staff in accordance with the following schedule for the calendar period in which samples were taken or observations made. The results of any monitoring done more frequently than required at the locations specified herein shall be reported to Board staff.

<u>Sampling Frequency</u>	<u>Reporting Frequency</u>	<u>Reporting Periods End</u>	<u>Report Date Due</u>
Monthly	Quarterly	Last Day of Month	by Quarterly Schedule
Quarterly	Quarterly	31 March	31 August
		30 June	31 August
		30 September	28 February
		31 December	28 February
Semi-Annually	Semi-Annually	30 June	31 August
		31 December	28 February
Annually	Annually	31 December	28 February

The annual report to be submitted to Board staff shall contain both tabular and graphical summaries of the monitoring data obtained during the previous twelve months, so as to show historical trends at each well. The report shall include a discussion of compliance with the waste discharge requirements and the water quality protection standard.

C. WATER QUALITY PROTECTION STANDARD AND COMPLIANCE PERIOD

1. Water Quality Protection Standard Report

For each waste management unit, the water quality protection standard consists of a list of constituents of concern and monitoring parameters, concentration limits for each constituent of concern, the point of compliance, and all monitoring points.

The Discharger shall submit a proposed water quality protection standard for review and approval within one year from the date of adoption of this Monitoring and Reporting Program by the Board. The Executive Officer shall review the data and the proposed water quality protection standard in determining the final water quality protection standard for each monitored medium.

MONITORING AND REPORTING PROGRAM No. 99-124
SOUTHEAST REGIONAL SOLID WASTE COMMISSION
POST-CLOSURE MAINTENANCE
SOUTHEAST REGIONAL MUNICIPAL SOLID WASTE LANDFILL
FRESNO COUNTY

-3-

The report shall:

- a) Identify **all distinct bodies of ground water** that could be affected in the event of a release from a waste management unit or portion of a waste management unit. This list shall include at least the uppermost aquifer and any permanent or ephemeral zones of perched groundwater underlying the waste management facility.
- b) Include a map showing the monitoring points and background monitoring points for the saturated zone(s) and showing the point of compliance in accordance with §20405 of Title 27.
- c) Evaluate the perennial direction(s) of groundwater movement within the uppermost groundwater zone(s).

If subsequent sampling of the background monitoring point(s) indicates significant water quality changes due to either seasonal fluctuations or other reasons unrelated to waste management activities at the site, the Discharger may request modification of the water quality protection standard.

2. **Constituents of Concern**

The constituents of concern are the waste constituents, reaction products, and hazardous constituents that are reasonably expected to be in or derived from waste contained in the waste management unit. The constituents of concern for all waste management units at the facility are those listed in Table IV. The Discharger shall monitor all constituents of concern in Table IV every five years, or more frequently as required in accordance with a Corrective Action Program.

a. **Monitoring Parameters**

Monitoring parameters are the waste constituents, reaction products, hazardous constituents, and physical parameters that provide a reliable indication of a release from a waste management unit. The monitoring parameters for all waste management units are those listed in Tables I through IV for the specified monitored medium.

3. **Concentration Limits**

The concentration limits for each constituent of concern are as follows:

- a. for naturally occurring constituents of concern, the concentration limit shall be the calculated statistical concentration limit.

MONITORING AND REPORTING PROGRAM NO. 99-124
SOUTHEAST REGIONAL SOLID WASTE COMMISSION
POST-CLOSURE MAINTENANCE
SOUTHEAST REGIONAL MUNICIPAL SOLID WASTE LANDFILL
FRESNO COUNTY

-4-

- b. for anthropogenic (not naturally occurring) constituents, which have no natural and, therefore, no background values, the concentration limit (water quality protection standard) shall be the detection limit of the analytical method(s) used.

The Discharger shall use the statistical method approved by the Executive Officer and the groundwater quality data obtained from the detection monitoring program to revise the concentration limits annually. The Discharger shall submit the revised concentration limits to the Executive Officer for review and approval in the annual monitoring report.

4. Point of Compliance

The point of compliance for each waste management unit is the vertical surface located at the hydraulically downgradient limit of the waste management unit that extends through the uppermost aquifer underlying the unit.

a. Monitoring Points

All downgradient wells established for groundwater monitoring shall constitute the monitoring points for the groundwater quality protection standard. All approved monitoring wells and leachate monitoring points shall be sampled and analyzed for monitoring parameters and constituents of concern as indicated and listed in Tables I through IV.

5. Compliance Period

The compliance period for each waste management unit shall be the number of years equal to the active life of the waste management unit plus the closure period. The compliance period is the minimum period during which the Discharger shall conduct a water quality monitoring program subsequent to a release from the unit. The compliance period shall begin anew each time the Discharger initiates an evaluation monitoring program.

D. MONITORING

The Discharger shall comply with the detection monitoring provisions of Title 27 for groundwater in accordance with Detection Monitoring Specification D.2 and D.3 of Waste Discharger Requirements Order No. 99-124. All monitoring shall be conducted in accordance with a Sample Collection and Analysis Plan, which includes quality assurance/quality control standards, that is acceptable to the Executive Officer.

MONITORING AND REPORTING PROGRAM No. 99-124
SOUTHEAST REGIONAL SOLID WASTE COMMISSION
POST-CLOSURE MAINTENANCE
SOUTHEAST REGIONAL MUNICIPAL SOLID WASTE LANDFILL
FRESNO COUNTY

-5-

Method detection limits and practical quantitation limits shall be reported. All peaks shall be reported, including those which cannot be quantified and/or specifically identified. Metals shall be analyzed in accordance with the methods listed in Table IV.

The Discharger may use alternative analytical test methods, including new EPA approved methods, provided the methods have method detection limits equal to or lower than the analytical methods specified in this Monitoring and Reporting Program.

1. Groundwater

The Discharger shall install and operate a groundwater detection monitoring system that complies with the applicable provisions of §20415 and §20420 of Title 27 in accordance with a Detection Monitoring Plan approved by the Executive Officer. The Discharger shall collect, preserve, and transport groundwater samples in accordance with the approved Sample Collection and Analysis Plan.

The Discharger shall determine groundwater flow rate and direction in the uppermost aquifer and in any zones of perched water and in any additional zone of saturation monitored pursuant to this Monitoring and Reporting Program, and report the results quarterly, including the times of highest and lowest elevations of the water levels in the wells.

Groundwater samples shall be collected from the point of compliance wells, background wells, and any additional wells added as part of the approved groundwater monitoring system. Samples shall be collected and analyzed for the monitoring parameters in accordance with the methods and frequency specified in Table I. All monitoring parameters shall be graphed so as to show historical trends at each well. The monitoring parameters shall also be evaluated annually with regards to the cation/anion balance, and the results shall be graphically presented using a Stiff diagram or a Piper graph. Samples for the constituents of concern specified in Table I shall be collected and analyzed in accordance with the methods listed in Table IV every five years.

2. Facility Monitoring

a. Facility Inspection

Annually, no later than 30 September and within 7 days following a major storm event, the Discharger shall conduct an inspection of the facility. The inspection shall assess damage to the drainage control system, groundwater monitoring equipment (including wells, etc.), and shall include the Standard Observations defined in the Standard Provisions and Reporting Requirements (Definition 24). Any necessary construction, maintenance, or repairs shall be

Aug. 97

MONITORING AND REPORTING PROGRAM NO. 99-124
SOUTHEAST REGIONAL SOLID WASTE COMMISSION
POST-CLOSURE MAINTENANCE
SOUTHEAST REGIONAL MUNICIPAL SOLID WASTE LANDFILL
FRESNO COUNTY

-6-

completed by 31 October and within 30 days of a major storm event. By 15 November of each year, and within 45 days of a major storm event, the Discharger shall submit an annual report describing the results of the inspection and the repair measures implemented.

b. Storm Events

The Discharger shall inspect all precipitation, diversion, and drainage facilities for damage within 7 days following *major storm events*. Necessary repairs shall be completed within 30 days of the inspection. The Discharger shall report any damage and subsequent repairs within 45 days of completion of the repairs.

The Discharger shall implement the above monitoring program on the effective date of this Program.

Ordered by:

GARY M. CARLTON, Executive Officer

17 September 1999

(Date)

DEE

MONITORING AND REPORTING PROGRAM No. 99-124
 SOUTHEAST REGIONAL SOLID WASTE COMMISSION
 POST-CLOSURE MAINTENANCE
 SOUTHEAST REGIONAL MUNICIPAL SOLID WASTE LANDFILL
 FRESNO COUNTY

TABLE I
GROUNDWATER DETECTION MONITORING PROGRAM

<u>Parameter</u>	<u>Units</u>	<u>Frequency</u>
Field Parameters		
Groundwater Elevation	Ft. & hundredths, M.S.L.	Quarterly
Temperature	°C	Quarterly
Specific Conductance	µmhos/cm	Quarterly
pH	pH units	Quarterly
Turbidity	Turbidity units	Quarterly
Monitoring Parameters		
Total Dissolved Solids (TDS)	mg/L	Semi-annual
Chloride	mg/L	Semi-annual
Carbonate	mg/L	Semi-annual
Bicarbonate	mg/L	Semi-annual
Nitrate - Nitrogen	mg/L	Semi-annual
Sulfate	mg/L	Semi-annual
Calcium	mg/L	Semi-annual
Magnesium	mg/L	Semi-annual
Potassium	mg/L	Semi-annual
Sodium	mg/L	Semi-annual
Volatile Organic Compounds (USEPA Methods 601/602, see Table III)	µg/L	Semi-annual
Constituents of Concern (see Table IV)		
Total Organic Carbon	mg/L	5 years
Inorganics (dissolved)	mg/L	5 years
Volatile Organic Compounds (USEPA Method 8260, extended list)	µg/L	5 years
Semi-Volatile Organic Compounds (USEPA Method 8270)	µg/L	5 years
Chlorophenoxy Herbicides (USEPA Method 8150)	µg/L	5 years
Organophosphorus Compounds (USEPA Method 8141)	µg/L	5 years

MONITORING AND REPORTING PROGRAM NO. 99-124
 SOUTHEAST REGIONAL SOLID WASTE COMMISSION
 POST-CLOSURE MAINTENANCE
 SOUTHEAST REGIONAL MUNICIPAL SOLID WASTE LANDFILL
 FRESNO COUNTY

TABLE II
LEACHATE DETECTION MONITORING PROGRAM

<u>Parameter</u>	<u>Units</u>	<u>Frequency</u>
Field Parameters		
Total Flow	Gallons	Quarterly
Flow Rate	Gallons/Day	Quarterly
Specific Conductance	µmhos/cm	Quarterly
pH	pH units	Quarterly
Monitoring Parameters		
Total Dissolved Solids (TDS)	mg/L	Quarterly
Chloride	mg/L	Quarterly
Sulfate	mg/L	Quarterly
Nitrate - Nitrogen	mg/L	Quarterly
Volatile Organic Compounds (USEPA Methods 601/602, see Table III)	µg/L	Quarterly
Constituents of Concern (see Table IV)		
Total Organic Carbon	mg/L	5 years
Carbonate	mg/L	5 years
Bicarbonate Alkalinity	mg/L	5 years
Inorganics (dissolved)	mg/L	5 years
Volatile Organic Compounds (USEPA Method 8260, extended list)	µg/L	5 years
Semi-Volatile Organic Compounds (USEPA Method 8270)	µg/L	5 years
Chlorophenoxy Herbicides (USEPA Method 8150)	µg/L	5 years
Organophosphorus Compounds (USEPA Method 8141)	µg/L	5 years

MONITORING AND REPORTING PROGRAM No. 99-124
SOUTHEAST REGIONAL SOLID WASTE COMMISSION
POST-CLOSURE MAINTENANCE
SOUTHEAST REGIONAL MUNICIPAL SOLID WASTE LANDFILL
FRESNO COUNTY

-9-

TABLE III
MONITORING PARAMETERS FOR DETECTION MONITORING

Constituents included in VOC:

USEPA Methods 601 and 602 Benzene
Bromodichloromethane
Bromoform (Tribromomethane)
Bromomethane
Carbon tetrachloride
Chlorobenzene
Chloroethane (Ethyl chloride)
Chloroform (Trichloromethane)
Chloromethane
Dibromochloromethane (Chlorodibromomethane)
o-Dichlorobenzene (1,2-Dichlorobenzene)
1,3-Dichlorobenzene
p-Dichlorobenzene (1,4-Dichlorobenzene)
Dichlorodifluoromethane
1,1-Dichloroethane (Ethylidene chloride)
1,2-Dichloroethane (Ethylene dichloride)
1,1 -Dichloroethylene (1,1 -Dichloroethene; Vinylidene chloride)
trans-1,2-Dichloroethylene (trans-1,2-Dichloroethene)
1,2-Dichloropropane (Propylene dichloride)
cis- 1,3-Dichloropropene
trans-1,3-Dichloropropene
Ethylbenzene
Methylene chloride (Dichloromethane)
1,1,2,2-Tetrachloroethane
Tetrachloroethylene (Tetrachloroethene; Perchloroethylene)
Toluene
1,1,1-Trichloroethane (Methylchloroform)
1,1,2-Trichloroethane
Trichloroethylene (Trichloroethene)
Trichlorofluoromethane (CFC- 11)
Vinyl chloride
Xylene(s)

MONITORING AND REPORTING PROGRAM NO. 99-124
 SOUTHEAST REGIONAL SOLID WASTE COMMISSION
 POST-CLOSURE MAINTENANCE
 SOUTHEAST REGIONAL MUNICIPAL SOLID WASTE LANDFILL
 FRESNO COUNTY

-10-

TABLE IV

CONSTITUENTS OF CONCERN & APPROVED USEPA ANALYTICAL METHODS

<u>Inorganics (dissolved):</u>	<u>USEPA Method</u>
Aluminum	6010
Antimony	6010
Barium	6010
Beryllium	6010
Cadmium	6010
Chromium	6010
Cobalt	6010
Copper	6010
Silver	6010
Tin	6010
Vanadium	6010
Zinc	6010
Iron	6010
Manganese	6010
Arsenic	7061
Lead	7421
Mercury	7470
Nickel	7520
Selenium	7741
Thallium	7841
Cyanide	9010
Sulfide	9030

Volatile Organic Compounds:

USEPA Method 8260

Acetone
 Acetonitrile (Methyl cyanide)
 Acrolein
 Acrylonitrile
 Allyl chloride (3-Chloropropene)
 Benzene
 Bis(2-ethylhexyl) phthalate
 Bromochloromethane (Chlorobromomethane)
 Bromodichloromethane (Dibromochloromethane)
 Bromoform (Tribromomethane)
 Carbon disulfide
 Carbon tetrachloride
 Chlorobenzene
 Chloroethane (Ethyl chloride)
 Chloroform (Trichloromethane)
 Chloroprene

MONITORING AND REPORTING PROGRAM No. 99-124
 SOUTHEAST REGIONAL SOLID WASTE COMMISSION
 POST-CLOSURE MAINTENANCE
 SOUTHEAST REGIONAL MUNICIPAL SOLID WASTE LANDFILL
 FRESNO COUNTY

-11-

TABLE IV

CONSTITUENTS OF CONCERN & APPROVED USEPA ANALYTICAL METHODS
 (Continued)

Dibromochloromethane (Chlorodibromomethane)
 1,2-Dibromo-3-chloropropane (DBCP)
 1,2-Dibromoethane (Ethylene dibromide; EDB)
 o-Dichlorobenzene (1,2-Dichlorobenzene)
 m-Dichlorobenzene (1,3-Dichlorobenzene)
 p-Dichlorobenzene (1,4-Dichlorobenzene)
 trans- 1,4-Dichloro-2-butene
 Dichlorodifluoromethane (CFC 12)
 1,1 -Dichloroethane (Ethylidene chloride)
 1,2-Dichloroethane (Ethylene dichloride)
 1,1 -Dichloroethylene (1, 1-Dichloroethene; Vinylidene chloride)
 cis- 1,2-Dichloroethylene (cis- 1,2-Dichloroethene)
 trans- 1,2-Dichloroethylene (trans- 1,2-Dichloroethene)
 1,2-Dichloropropane (Propylene dichloride)
 1,3-Dichloropropane (Trimethylene dichloride)
 2,2-Dichloropropane (Isopropylidene chloride)
 1,1 -Dichloropropene
 cis- 1,3-Dichloropropene
 trans- 1,3-Dichloropropene
 Ethylbenzene
 Hexachlorobutadiene
 2-Hexanone (Methyl butyl ketone)
 Isobutyl alcohol
 Isodrin
 Methacrylonitrile
 Methyl bromide (Bromomethane)
 Methyl chloride (Chloromethane)
 Methyl ethyl ketone (MEK; 2-Butanone)
 Methyl iodide (Iodomethane)
 Methyl methacrylate
 4-Methyl-2-pentanone (Methyl isobutyl ketone)
 Methylene bromide (Dibromomethane)
 Methylene chloride (Dichloromethane)
 Naphthalene
 Propionitrile (Ethyl cyanide)
 Styrene
 1,1,1,2-Tetrachloroethane
 1,1,2,2-Tetrachloroethane
 Tetrachloroethylene (Tetrachloroethene; Perchloroethylene; PCE)
 Toluene 1,2,4-Trichlorobenzene
 1,1,1 -Trichloroethane, Methylchloroform
 1,1,2-Trichloroethane

MONITORING AND REPORTING PROGRAM NO. 99-124
 SOUTHEAST REGIONAL SOLID WASTE COMMISSION
 POST-CLOSURE MAINTENANCE
 SOUTHEAST REGIONAL MUNICIPAL SOLID WASTE LANDFILL
 FRESNO COUNTY

-12-

TABLE IV

CONSTITUENTS OF CONCERN & APPROVED USEPA ANALYTICAL METHODS
 (Continued)

Trichloroethylene (Trichloroethene; TCE)
 Trichlorofluoromethane (CFC- 11)
 1,2,3-Trichloropropane
 Vinyl acetate
 Vinyl chloride (Chloroethene)
 Xylene (total)

Semi-Volatile Organic Compounds:

USEPA Method 8270 - base, neutral, & acid extractables

Acenaphthene
 Acenaphthylene
 Acetophenone
 2-Acetylaminofluorene (2-AAF)
 Aldrin
 4-Aminobiphenyl
 Anthracene
 Benzo[a]anthracene (Benzanthracene)
 Benzo[b]fluoranthene
 Benzo[k]fluoranthene
 Benzo[g,h,i]perylene
 Benzo[a]pyrene
 Benzyl alcohol
 alpha-BHC
 beta-BHC
 delta-BHC
 gamma-BHC (Lindane)
 Bis(2-chloroethoxy)methane
 Bis(2-chloroethyl) ether (Dichloroethyl ether)
 Bis(2-chloro-1-methylethyl) ether (Bis(2-chloroisopropyl) ether; DCIP)
 4-Bromophenyl phenyl ether
 Butyl benzyl phthalate (Benzyl butyl phthalate)
 Chlordane
 p-Chloroaniline
 Chlorobenzilate
 p-Chloro-m-cresol (4-Chloro-3-methylphenol)
 2-Chloronaphthalene
 2-Chlorophenol
 4-Chlorophenyl phenyl ether
 Chrysene
 o-Cresol (2-methylphenol)
 m-Cresol (3-methylphenol)

MONITORING AND REPORTING PROGRAM No. 99-124
SOUTHEAST REGIONAL SOLID WASTE COMMISSION
POST-CLOSURE MAINTENANCE
SOUTHEAST REGIONAL MUNICIPAL SOLID WASTE LANDFILL
FRESNO COUNTY

-13-

TABLE IV
CONSTITUENTS OF CONCERN & APPROVED USEPA ANALYTICAL METHODS
(Continued)

p-Cresol (4-methylphenol)
4,4'-DDD
4,4'-DDE
4,4'-DDT
Diallate
Dibenz[a,h]anthracene
Dibenzofuran
Di-n-butyl phthalate
o-Dichlorobenzene (1,2-Dichlorobenzene)
m-Dichlorobenzene (1,3-Dichlorobenzene)
p-Dichlorobenzene (1,4-Dichlorobenzene)
3,3'-Dichlorobenzidine
2,4-Dichlorophenol
2,6-Dichlorophenol
Dieldrin
Diethyl phthalate
p-(Dimethylamino)azobenzene
7,12-Dimethylbenz[a]anthracene
3,3'-Dimethylbenzidine
2,4-Dimethylphenol (m-Xylenol)
Dimethyl phthalate
m-Dinitrobenzene
4,6-Dinitro-o-cresol (4,6-Dinitro-2-methylphenol)
2,4-Dinitrophenol
2,4-Dinitrotoluene
2,6-Dinitrotoluene
Di-n-octyl phthalate
Diphenylamine
Endosulfan I
Endosulfan II
Endosulfan sulfate
Endrin
Endrin aldehyde
Ethyl methacrylate
Ethyl methanesulfonate
Famphur
Fluoranthene
Fluorene
Heptachlor
Heptachlor epoxide
Hexachlorobenzene
Hexachlorobutadiene

MONITORING AND REPORTING PROGRAM NO. 99-124
 SOUTHEAST REGIONAL SOLID WASTE COMMISSION
 POST-CLOSURE MAINTENANCE
 SOUTHEAST REGIONAL MUNICIPAL SOLID WASTE LANDFILL
 FRESNO COUNTY

-14-

TABLE IV

CONSTITUENTS OF CONCERN & APPROVED USEPA ANALYTICAL METHODS
 (Continued)

Hexachlorocyclopentadiene
 Hexachloroethane
 Hexachloropropene
 Indeno(1,2,3-c,d)pyrene
 Isophorone
 Isosafrole
 Kepone
 Methapyrilene
 Methoxychlor
 3-Methylcholanthrene
 Methyl methanesulfonate
 2-Methylnaphthalene
 Naphthalene
 1,4-Naphthoquinone
 1-Naphthylamine
 2-Naphthylamine
 o-Nitroaniline (2-Nitroaniline)
 m-Nitroaniline (3-Nitroaniline)
 p-Nitroaniline (4-Nitroaniline)
 Nitrobenzene
 o-Nitrophenol (2-Nitrophenol)
 p-Nitrophenol (4-Nitrophenol)
 N-Nitrosodi-n-butylamine (Di-n-butylnitrosamine)
 N-Nitrosodiethylamine (Diethylnitrosamine)
 N-Nitrosodimethylamine (Dimethylnitrosamine)
 N-Nitrosodiphenylamine (Diphenylnitrosamine)
 N-Nitrosodipropylamine (N-Nitroso-N-dipropylamine; Di-n-propylnitrosamine)
 N-Nitrosomethylethylamine (Methylethylnitrosamine)
 N-Nitrosopiperidine
 N-Nitrosopyrrolidine
 5-Nitro-o-toluidine
 Pentachlorobenzene
 Pentachloronitrobenzene (PCNB)
 Pentachlorophenol
 Phenacetin
 Phenanthrene
 Phenol
 p-Phenylenediamine
 Polychlorinated biphenyls (PCBs; Aroclors)
 Pronamide
 Pyrene
 Safrole

MONITORING AND REPORTING PROGRAM No. 99-124
SOUTHEAST REGIONAL SOLID WASTE COMMISSION
POST-CLOSURE MAINTENANCE
SOUTHEAST REGIONAL MUNICIPAL SOLID WASTE LANDFILL
FRESNO COUNTY

-15-

TABLE IV
CONSTITUENTS OF CONCERN & APPROVED USEPA ANALYTICAL METHODS
(Continued)

1,2,4,5-Tetrachlorobenzene
2,3,4,6-Tetrachlorophenol
o-Toluidine
Toxaphene
1,2,4-Trichlorobenzene
2,4,5-Trichlorophenol
1,2,4,6-Trichlorophenol
0,0,0-Triethyl phosphorothioate
sym-Trinitrobenzene

Chlorophenoxy Herbicides:

USEPA Method 8150

2,4-D (2,4-Dichlorophenoxyacetic acid)
Dinoseb (DNBP; 2-sec-Butyl-4,6-dinitrophenol)
Silvex (2,4,5-Trichlorophenoxypropionic acid; 2,4,5-TP)
2,4,5-T (2,4,5-Trichlorophenoxyacetic acid)

Organophosphorus Compounds:

USEPA Method 8141

0,0-Diethyl 0-2-pyrazinyl phosphorothioate (Thionazin)
Dimethoate
Disulfoton
Methyl parathion (Parathion methyl)
Parathion
Phorate

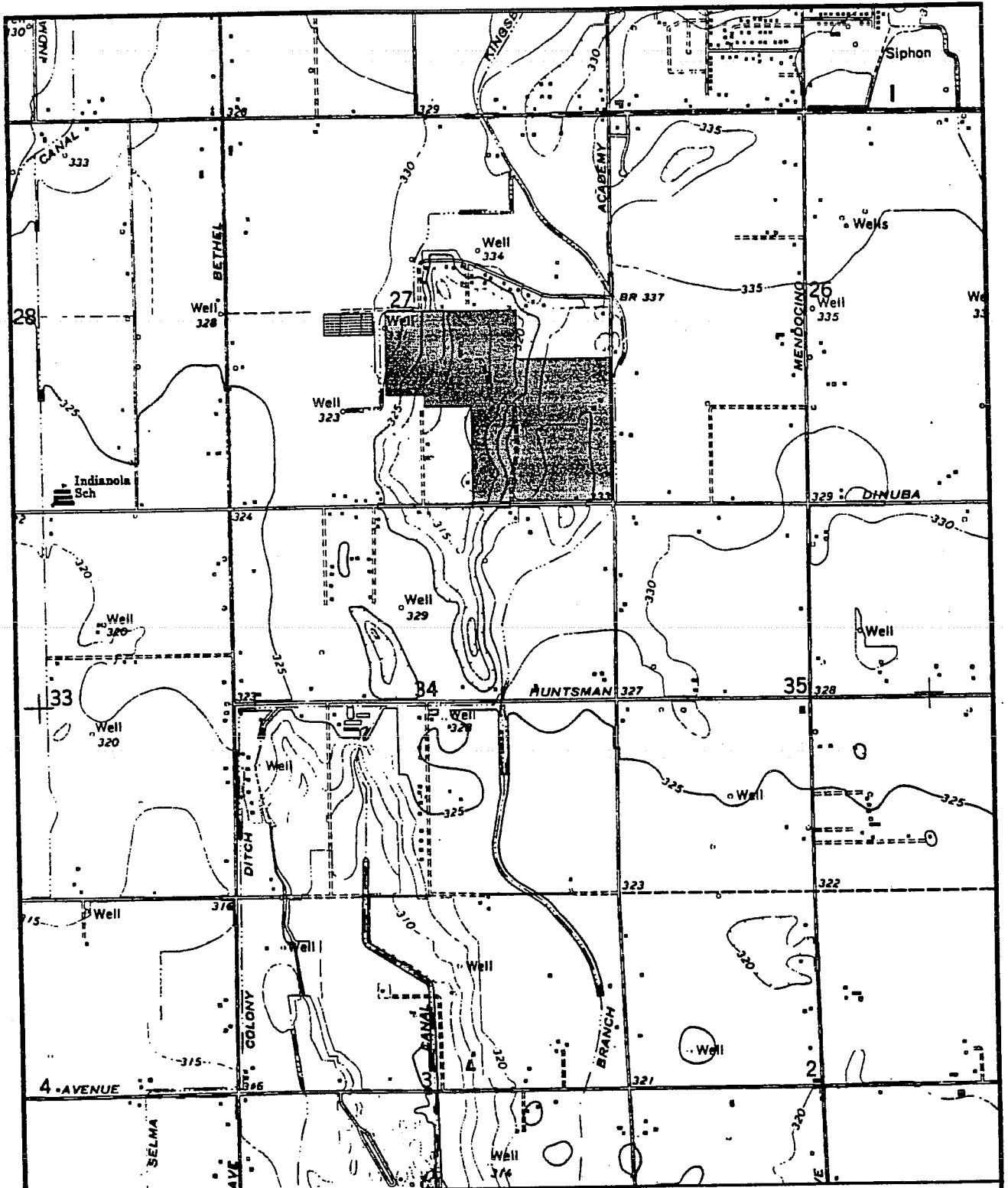

ATTACHMENT A

ORDER NO. _____

**SOUTHEAST REGIONAL SOLID WASTE COMMISSION
SOUTHEAST REGIONAL MUNICIPAL SOLID WASTE LANDFILL
FRESNO COUNTY**



1" = 2000'

Selma, CA U.S.G.S. 7 1/2 Min. Quadrangle